

**Parcel Number**

06222003D

**Owner**

KERR  
DAISEY  
PAULETTE

**Mailing Address**

1325 PROVIDENCE RD  
CHARLOTTE  
NC, 28207

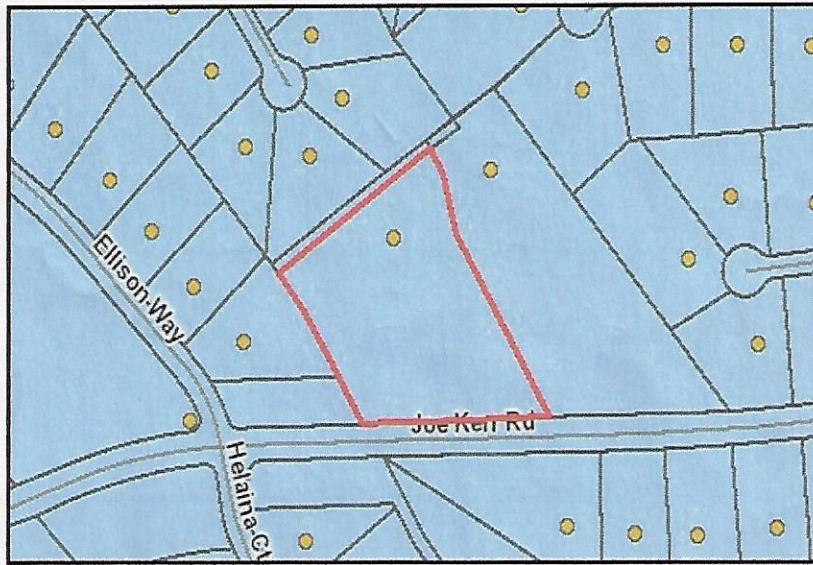

**Account Information**

Land Value \$195,800.00  
Building Value \$201,400.00  
Total Value \$397,200.00  
Acreage 3.6800

Description J. DONALD KERR  
Situs Address 9614 JOE KERR RD  
Property Class RESIDENTIAL

**Sales Information**

Sale Date	Sale Amount	Book & Page	Grantor
06/17/2020	\$0.00	D145 0655	KERR, J DONALD
06/17/2020	\$0.00	W20E 795	KERR, J DONALD HEIRS
09/16/2016	\$0.00	6771 204	KERR J DONALD

**Location Information**

Municipal Administration	Marvin	12 Mile Service Area	No
County Zoning Code	CITY	School	<a href="#">School Assignment Information</a>
Zoning Administration	Marvin	Census Tract Number	210.07
ETJ		FEMA Panel	4456
Fire District	Wesley Chapel	FEMA Zone	
Soils	IrA,LdB2		

**Building Information [View Real Property Site](#)**

Total Living Area 1784  
Year Build 1961

**District Voting Assignments (Jurisdictions)**

Polling Place	MARVIN ELEMENTARY SCHOOL	School District	6	Congressional District	9
Precinct District	#28B	State House	68	Senate District	35