



Out of City Limits
WATER AND/OR SEWER SERVICE REQUEST
Operations Center 704-282-4601

Applicant Name: Better Path Homes LLC

Email address: grace@choosebetterpath.com

Phone number: 704-516-1961

Property Address: None Assigned

Tax Map Parcel Number 091 - 25 - 039 **Parcel Size (Acres)** 0.51

☒ **Water Service**

Request for Water Service is being submitted for the following reason(s).

☒ **New Construction**

☐ **Existing Well Failure.** Provide brief description: _____

☐ **Sewer Service**

Request for Sewer Service is being submitted for the following reason(s).

☐ **New Construction**

☐ **Existing Septic System Failure**

Out of City Limits - Water and Sewer Service Terms and Conditions

- All requests are subject to Union County Commission and City of Monroe Council approval.
- The Property Owner shall comply with the City of Monroe Water and/or Sewer Ordinances.
- An evaluation of voluntary annexation will be conducted.
- Property Owner shall pay the appropriate tap and capacity fees for outside City customers based on the prevailing fee schedule and will be required to set up an account with the City of Monroe Customer Service Department.
- Property Owner shall acquire all necessary offsite easements if required to connect to the City's water distribution and/or sewer collection system. A copy of the recorded private easement(s) shall be provided to the City of Monroe Water Resources Department.
- Upon payment of fees and completion of the water and/or sewer tap, billing shall begin immediately.
- Water services shall be per the City of Monroe Specifications and shall have remote radio read technology.
- Property Owner shall notify the City of Monroe prior to making the connection to the sewer tap to schedule an onsite inspection of the installation. Only one (1) property parcel shall be connected to the sewer tap.
- Property Owner agrees that the sewer tap shall be maintained by the City of Monroe at the Property Owner's expense.
- If a private grinder pump and sewer forcemain is required, the Property Owner shall install #12 gage coated plastic copper wire taped to the service lateral from the connection to the sewer tap to the house connection.
- Property Owner shall assume ownership and maintenance responsibility for the service forcemain and the sewer pump and all other plumbing past the sewer tap.
- Property Owner shall agree to pay a monthly flat rate sewer bill if water service is from a private well.
- Property Owner agrees that if the property is ever sold that he/she shall provide the new owner a copy of this Service Request/Terms and Conditions and shall fully explain the conditions, responsibilities and precise location of the private water service and/or sewer lateral or forcemain if a private pump is installed.
- Depending upon schedules for the Union County Commissioners meetings and Monroe City Council meetings, the total timeframe for service approval can take as long as 3-5 months.

I hereby certify that the information provided is, to the best of my knowledge, correct and complete. I understand that I must adhere to the City of Monroe's Out of City Limits – Water and Sewer Service Terms and Conditions as outlined above. I also understand that any approval may be revoked and penalties imposed under the City's ordinance if this certification is not complete and true or for failure to comply with the Terms and Conditions.

Better Path Homes

Applicant's Signature

06/17/25

Date



Out of City Limits
WATER AND/OR SEWER SERVICE REQUEST
Operations Center 704-282-4601

Applicant Name: Better Path Homes LLC

Email address: grace@choosebetterpath.com

Phone number: 704-516-1961

Property Address: None Assigned

Tax Map Parcel Number 091 - 25 - 040

Parcel Size (Acres) 0.55

☒ **Water Service**

Request for Water Service is being submitted for the following reason(s).

☒ **New Construction**

☐ **Existing Well Failure.** Provide brief description: _____

☐ **Sewer Service**

Request for Sewer Service is being submitted for the following reason(s).

☐ **New Construction**

☐ **Existing Septic System Failure**

Out of City Limits - Water and Sewer Service Terms and Conditions

- All requests are subject to Union County Commission and City of Monroe Council approval.
- The Property Owner shall comply with the City of Monroe Water and/or Sewer Ordinances.
- An evaluation of voluntary annexation will be conducted.
- Property Owner shall pay the appropriate tap and capacity fees for outside City customers based on the prevailing fee schedule and will be required to set up an account with the City of Monroe Customer Service Department.
- Property Owner shall acquire all necessary offsite easements if required to connect to the City's water distribution and/or sewer collection system. A copy of the recorded private easement(s) shall be provided to the City of Monroe Water Resources Department.
- Upon payment of fees and completion of the water and/or sewer tap, billing shall begin immediately.
- Water services shall be per the City of Monroe Specifications and shall have remote radio read technology.
- Property Owner shall notify the City of Monroe prior to making the connection to the sewer tap to schedule an onsite inspection of the installation. Only one (1) property parcel shall be connected to the sewer tap.
- Property Owner agrees that the sewer tap shall be maintained by the City of Monroe at the Property Owner's expense.
- If a private grinder pump and sewer forcemain is required, the Property Owner shall install #12 gage coated plastic copper wire taped to the service lateral from the connection to the sewer tap to the house connection.
- Property Owner shall assume ownership and maintenance responsibility for the service forcemain and the sewer pump and all other plumbing past the sewer tap.
- Property Owner shall agree to pay a monthly flat rate sewer bill if water service is from a private well.
- Property Owner agrees that if the property is ever sold that he/she shall provide the new owner a copy of this Service Request/Terms and Conditions and shall fully explain the conditions, responsibilities and precise location of the private water service and/or sewer lateral or forcemain if a private pump is installed.
- Depending upon schedules for the Union County Commissioners meetings and Monroe City Council meetings, the total timeframe for service approval can take as long as 3-5 months.

I hereby certify that the information provided is, to the best of my knowledge, correct and complete. I understand that I must adhere to the City of Monroe's Out of City Limits – Water and Sewer Service Terms and Conditions as outlined above. I also understand that any approval may be revoked and penalties imposed under the City's ordinance if this certification is not complete and true or for failure to comply with the Terms and Conditions.

Better Path Homes

Applicant's Signature

06/17/25

Date



Out of City Limits
WATER AND/OR SEWER SERVICE REQUEST
Operations Center 704-282-4601

Applicant Name: Better Path Homes LLC

Email address: grace@choosebetterpath.com

Phone number: 704-516-1961

Property Address: None Assigned

Tax Map Parcel Number 091 - 25 - 041

Parcel Size (Acres) 0.48

☒ **Water Service**

Request for Water Service is being submitted for the following reason(s).

☒ **New Construction**

☐ **Existing Well Failure.** Provide brief description: _____

☐ **Sewer Service**

Request for Sewer Service is being submitted for the following reason(s).

☐ **New Construction**

☐ **Existing Septic System Failure**

Out of City Limits - Water and Sewer Service Terms and Conditions

- All requests are subject to Union County Commission and City of Monroe Council approval.
- The Property Owner shall comply with the City of Monroe Water and/or Sewer Ordinances.
- An evaluation of voluntary annexation will be conducted.
- Property Owner shall pay the appropriate tap and capacity fees for outside City customers based on the prevailing fee schedule and will be required to set up an account with the City of Monroe Customer Service Department.
- Property Owner shall acquire all necessary offsite easements if required to connect to the City's water distribution and/or sewer collection system. A copy of the recorded private easement(s) shall be provided to the City of Monroe Water Resources Department.
- Upon payment of fees and completion of the water and/or sewer tap, billing shall begin immediately.
- Water services shall be per the City of Monroe Specifications and shall have remote radio read technology.
- Property Owner shall notify the City of Monroe prior to making the connection to the sewer tap to schedule an onsite inspection of the installation. Only one (1) property parcel shall be connected to the sewer tap.
- Property Owner agrees that the sewer tap shall be maintained by the City of Monroe at the Property Owner's expense.
- If a private grinder pump and sewer forcemain is required, the Property Owner shall install #12 gage coated plastic copper wire taped to the service lateral from the connection to the sewer tap to the house connection.
- Property Owner shall assume ownership and maintenance responsibility for the service forcemain and the sewer pump and all other plumbing past the sewer tap.
- Property Owner shall agree to pay a monthly flat rate sewer bill if water service is from a private well.
- Property Owner agrees that if the property is ever sold that he/she shall provide the new owner a copy of this Service Request/Terms and Conditions and shall fully explain the conditions, responsibilities and precise location of the private water service and/or sewer lateral or forcemain if a private pump is installed.
- Depending upon schedules for the Union County Commissioners meetings and Monroe City Council meetings, the total timeframe for service approval can take as long as 3-5 months.

I hereby certify that the information provided is, to the best of my knowledge, correct and complete. I understand that I must adhere to the City of Monroe's Out of City Limits – Water and Sewer Service Terms and Conditions as outlined above. I also understand that any approval may be revoked and penalties imposed under the City's ordinance if this certification is not complete and true or for failure to comply with the Terms and Conditions.

Better Path Homes

Applicant's Signature



06/17/25

Date

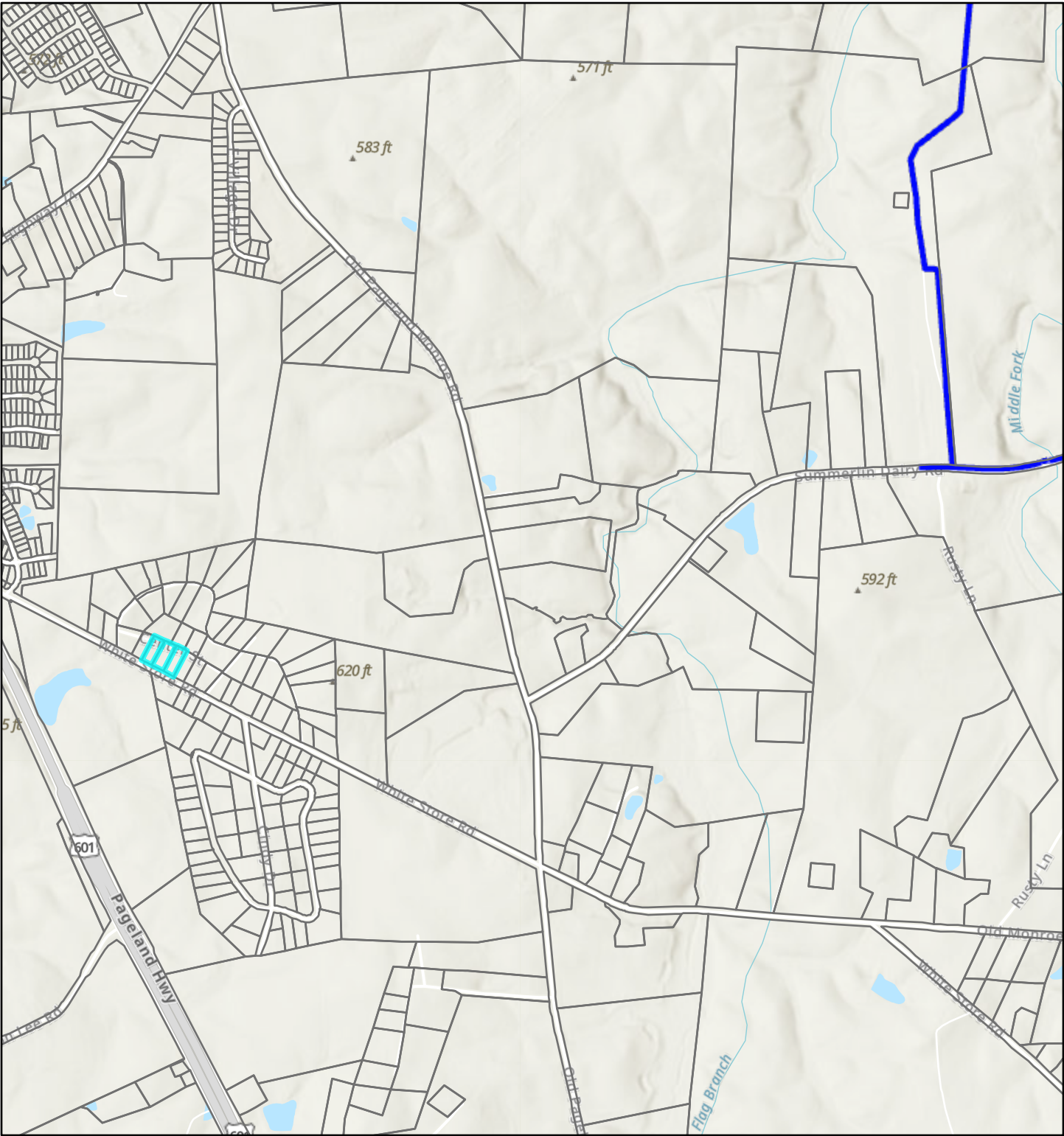
Union County GIS Map



7/15/2025, 12:25:54 PM

-  Parcels
-  Water Main

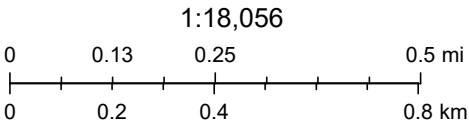

Esri, NASA, NGA, USGS, FEMA, Esri Community Maps Contributors, State of North Carolina DOT, Esri, TomTom, Garmin, SafeGraph, GeoTechnologies, Inc, METI/NASA, USGS, EPA, NPS, US Census Bureau, USDA, USFWS